

de Montageanleitung
en Mounting instructions
fr Instructions de montage
sv Monteringsinstruktion
nl Montage-handleiding
it Istruzioni di montaggio
fi Asennusohje
es Instrucciones de montaje
da Monteringsvejledning
pl Instrukcja montażu
cz Montážní návod
hu Szerelési útmutató
el Οδηγίες εγκατάστασης
ru Инструкция по установке
zh 安裝指導

Ventile PN16
Valves PN16
Vannes PN16
Ventiler PN16
Afsluiters PN16
Valvole PN16
Venttiilit PN16
Válvulas PN16
Ventiler PN16
Zawory PN16
Ventily PN16
Szelepek PN16
Βάνες PN16
Клапаны PN16
阀门 PN16

VVI46..
VXI46..

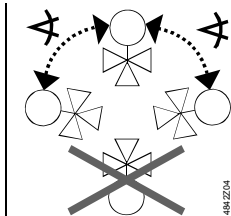

V.. + SFA.. : 2 x 85°

V.. + STA.. / STS61.. : 2 x 90°



1a

VVI46..

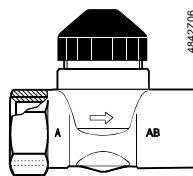

2a

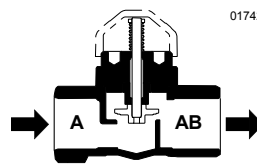

A → AB = 0 ... 100 %

3a

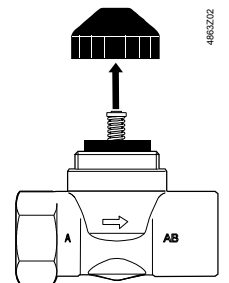

1b

VXI46..

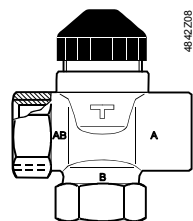

2b

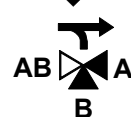
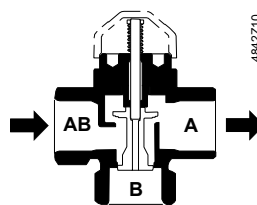

AB → A = 0 ... 100 %
 AB → B = 70 ... 0 %

3b

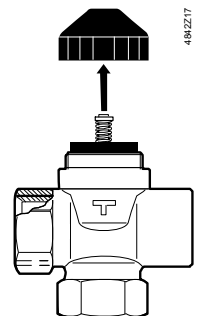

4

V..I46 + SFA..

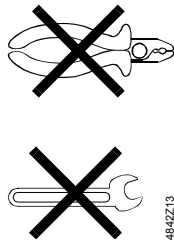
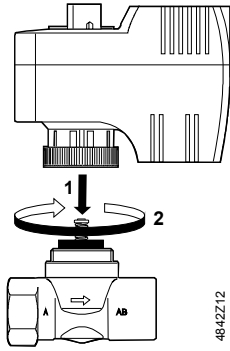

4842Z13

V..I46 + STA.. / STS61..

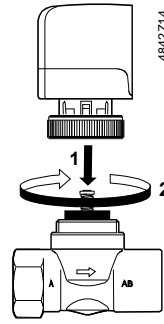

VXI46.. + SFA.. / STS61..

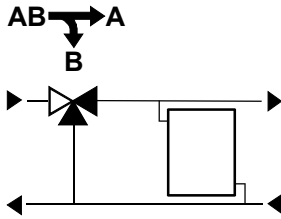

MXE..

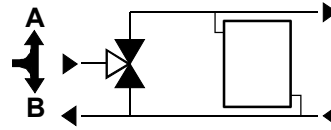

VVI46..

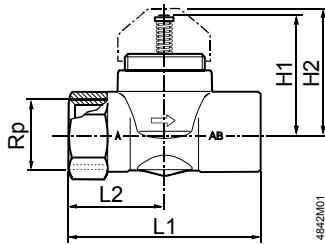

VXI46..

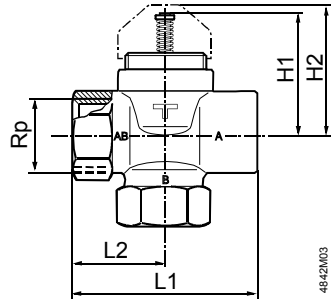

	DN	Rp	H1	H2	L1	L2
		[Inch]	[mm]	[mm]	[mm]	[mm]
VVI46.15	15	Rp 1/2	45,2	48	60	30
VVI46.20	20	Rp 3/4	45,2	48	65	32,5
VVI46.25	25	Rp 1	45,2	48	84	42

	DN	Rp	H1	H2	L1	L2
		[Inch]	[mm]	[mm]	[mm]	[mm]
VXI46.15	15	Rp 1/2	45,2	48	60	30
VXI46.20	20	Rp 3/4	45,2	48	65	32,5
VXI46.25	25	Rp 1	45,2	48	84	42
VXI46.25T	25	Rp 1	45,2	48	84	42