

SIEMENS

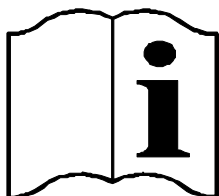

RDG160KN

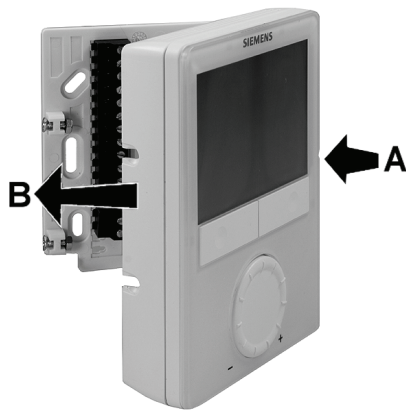

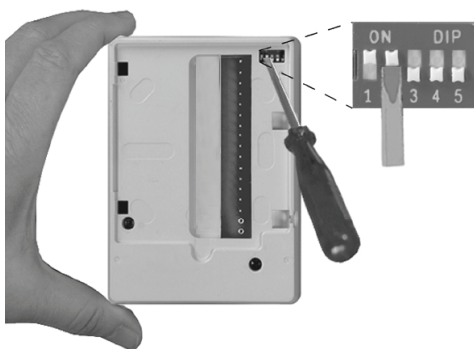
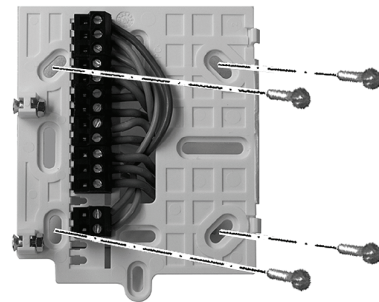
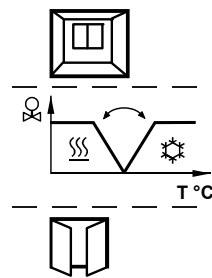
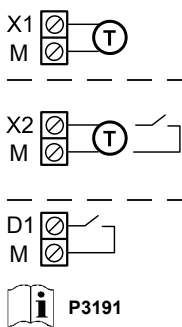
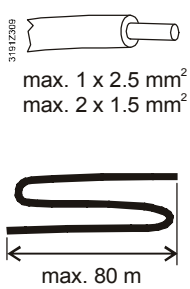
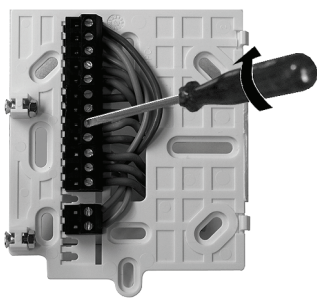
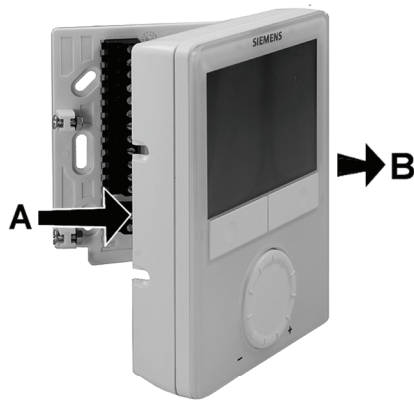
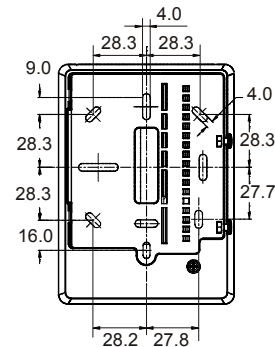
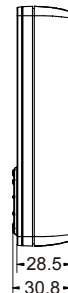
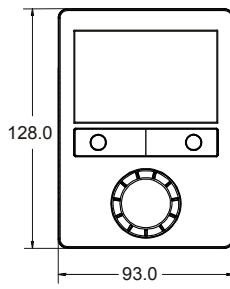
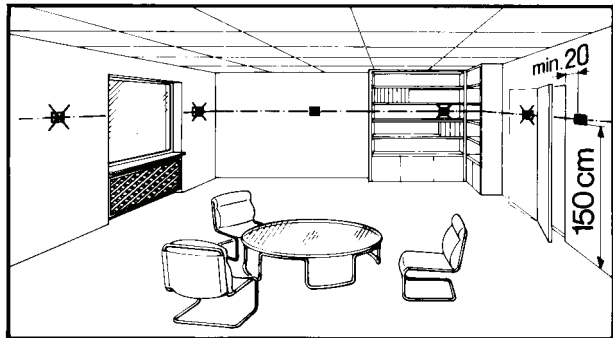
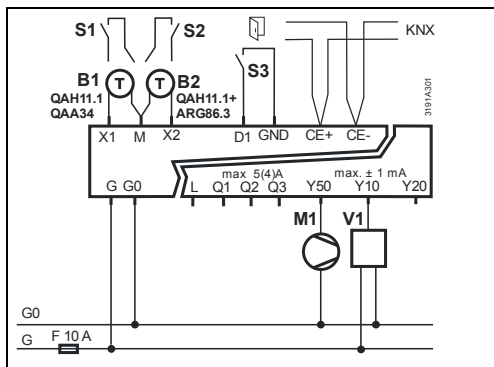

a Outputs	DC DC	2-pos DC	3-speed DC
① 2-pipe	V1 Y10	Q1 P46=1 (2-pos)	Y10

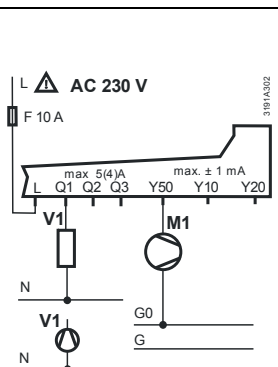

a Outputs	DC DC	2-pos DC	3-speed DC
① 2-pipe	V1 Y10	Q1 P46=1 (2-pos)	Y10

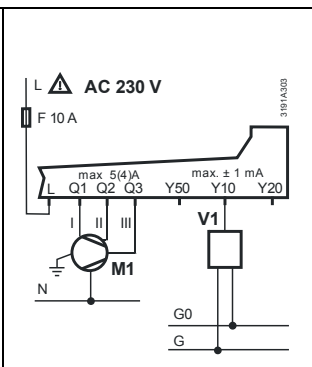

a Outputs	DC DC	2-pos DC	3-speed DC
① 2-pipe	V1 Y10	Q1 P46=1 (2-pos)	Y10

- i**
- ① ... ⑤
 - a** Output → AC 230 V, 2-pos or DC 0...10 V
 -
 -
 - L,N 230 VAC: → P01...Pn
P46 = 1 → V1 2-pos
P46 = 2 → V1 DC
P47 = 1 → V2 2-pos
P47 = 2 → V2 DC

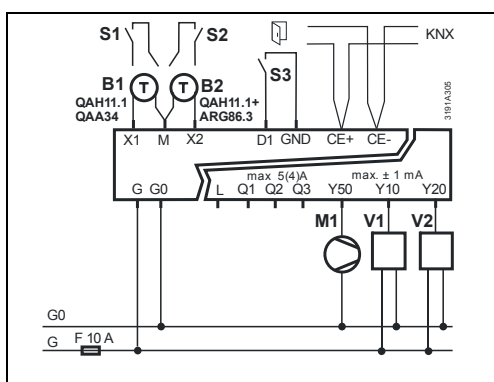

a Outputs	DC DC DC	2-pos 2-pos DC	2-pos DC DC	3-speed DC DC
② 2-pipe & el. heater	V1 Y10	Q1 Q2	Y10	Y10
③ 2-pipe & radiator	V1 RAD	Q1 Q2	Y10	Y10
④ 4-pipe	V1 1 st	Q1 Q2	Y10	Y10
⑤ 2-stage	V1 2 nd	Q1 Q2	Y10	Y10

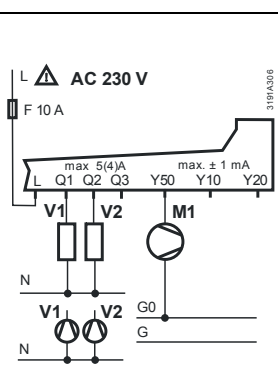

a Outputs	DC DC DC	2-pos 2-pos DC	2-pos DC DC	3-speed DC DC
② 2-pipe & el. heater	V1 Y10	Q1 Q2	Y10	Y10
③ 2-pipe & radiator	V1 RAD	Q1 Q2	Y10	Y10
④ 4-pipe	V1 1 st	Q1 Q2	Y10	Y10
⑤ 2-stage	V1 2 nd	Q1 Q2	Y10	Y10

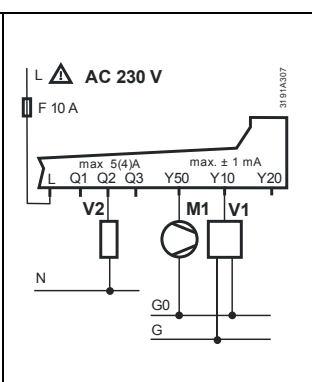

a Outputs	DC DC DC	2-pos 2-pos DC	2-pos DC DC	3-speed DC DC
② 2-pipe & el. heater	V1 Y10	Q1 Q2	Y10	Y10
③ 2-pipe & radiator	V1 RAD	Q1 Q2	Y10	Y10
④ 4-pipe	V1 1 st	Q1 Q2	Y10	Y10
⑤ 2-stage	V1 2 nd	Q1 Q2	Y10	Y10

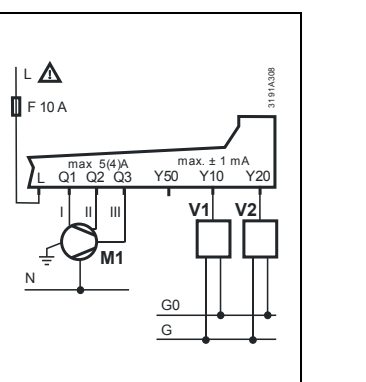

a Outputs	DC DC DC	2-pos 2-pos DC	2-pos DC DC	3-speed DC DC
② 2-pipe & el. heater	V1 Y10	Q1 Q2	Y10	Y10
③ 2-pipe & radiator	V1 RAD	Q1 Q2	Y10	Y10
④ 4-pipe	V1 1 st	Q1 Q2	Y10	Y10
⑤ 2-stage	V1 2 nd	Q1 Q2	Y10	Y10

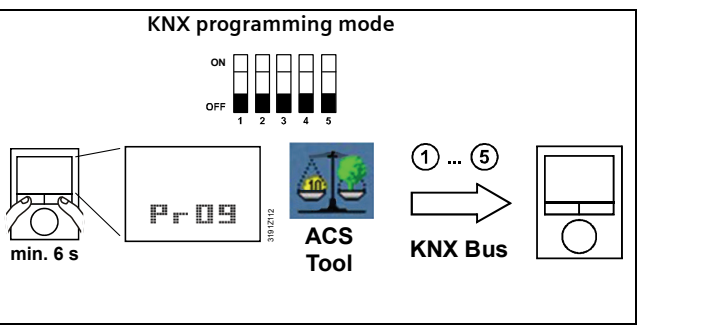
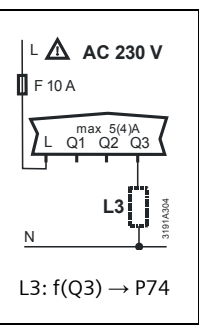
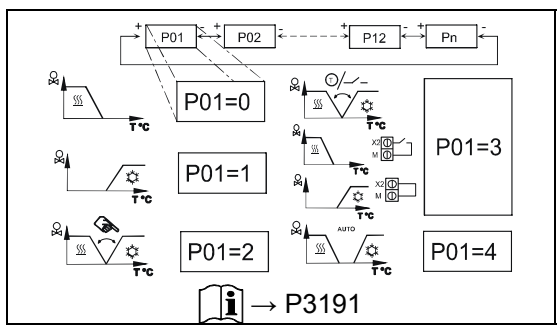

	en	de	fr	it	es	nl	tr
①	2-pipe fan coil	2-Rohr Ventilator-konvektor	Ventiloconvecteur 2 tubes	Fan coil 2 tubi	Fancoil a dos tubos	2-pijps fan coil	2 borulu fan coil
②	2-pipe & el. heater	2-Rohranwendung & Elektroheizung	Application 2 tubes & batterie électrique	Fan coil 2 tubi con batteria elettrica	2 tubos & batería eléctrica	2-pijps + elektrische verwarmers	2 borulu & elk. ısıtıcı
③	2-pipe & radiator	2-Rohranwendung & Radiator	Application 2 tubes & radiateur	Fan coil 2 tubi e radiatore	2 tubos & radiador	2-pijps + radiator	2 borulu & radyatör
④	4-pipe fan coil	4-Rohr Ventilator-konvektor	Ventiloconvecteur 4 tubes	Fan coil 4 tubi	Fancoil a 4 tubos	4-pijps fan coil	4 borulu fan coil
⑤	2-stage	2-Stufen-Anwendung	Application à 2 étages	2 stadi	2 etapas	2-traps	2 kademe